

hp MEDIASMART SERVER

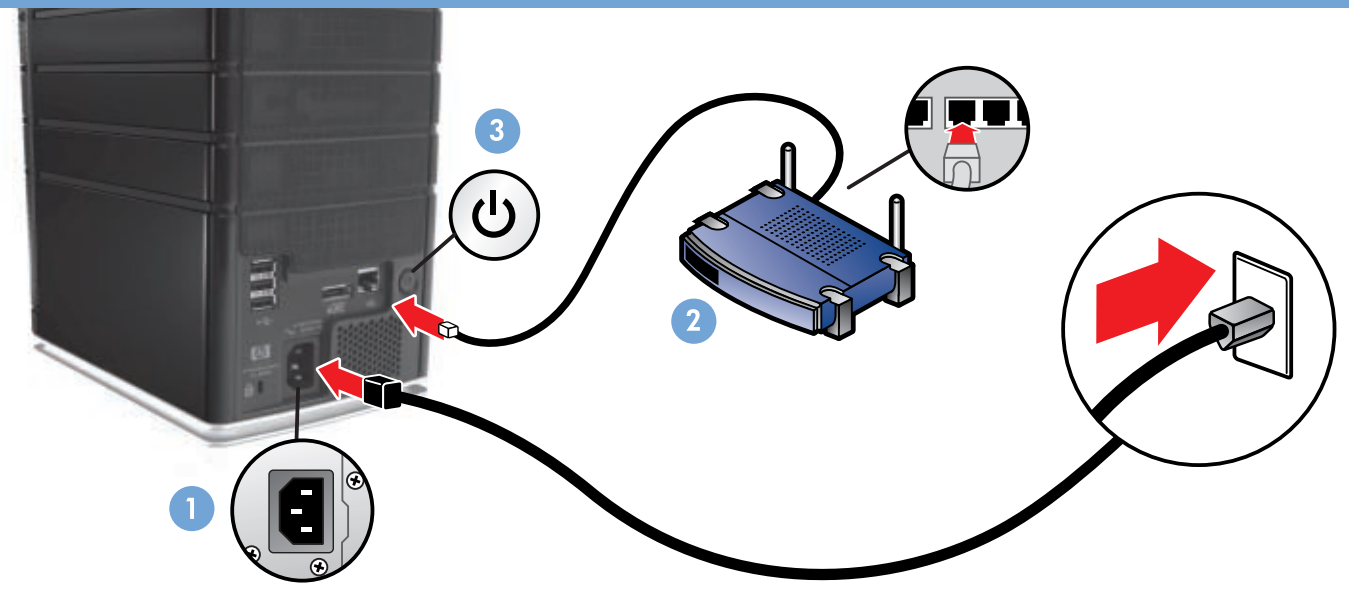

SETUP POSTER English

1 SET UP YOUR HP MEDIASMART SERVER



! IMPORTANT
Open the HP MediaSmart Server door and remove the foam packaging before connecting the server to your network and turning it on.

- 1 Plug the power cord into the server and the other end into an electrical outlet.
- 2 Connect one end of the Ethernet cable to the server and the other end to an available Ethernet port on your router.
- 3 Press the Power button on the back of the server.

The server will take approximately 60 seconds to start up. The LED indicator lights blink and change color throughout the startup process. Wait for all of the server LED lights to be pulsating aqua white before proceeding with the software installation.

Note: Firewall and anti-virus software installed on your computer may prevent the computer from locating the HP MediaSmart Server on your network. To ensure open communication between the computer and the server, complete the following steps prior to running the Software Installation Disc:

- Open the firewall and anti-virus software and update the trusted programs list
- Verify that both applications are set to "Learn" new programs
- Install any updates for the firewall or anti-virus software

WHAT'S INSIDE?

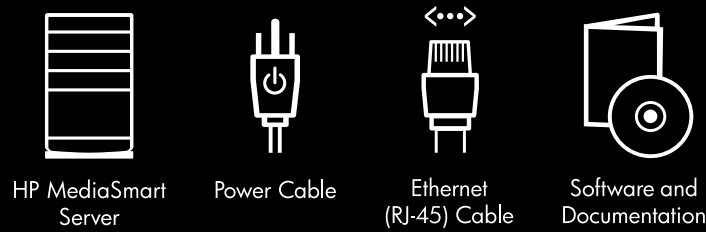

Before you begin, you will need

- One or more computers running Microsoft Windows® Vista, Windows® XP, Windows® MCE, or Mac® OS X 10.5 or later*
- A router with DHCP enabled to provide an automatic IP address to the server
- A broadband connection, such as DSL or cable, is required for remote access functionality
- 100 Mbps to 1000 Mbps (Gigabit Ethernet) wired network connection

*See the online help for a detailed list of supported operating systems.

2 INSTALL THE SOFTWARE ON YOUR FIRST COMPUTER



! IMPORTANT

If required, HP Update, Windows Installer 3.1, and .NET 2.0 or later software may be installed. These installations may restart your computer and take several minutes.

The first installation must be on a Windows computer. Subsequent installations can be on a Windows or Mac home computer.

To install the software, you must also have administrative privileges. Complete the following instructions to add administrative privileges to a user account on your home computer.

WINDOWS® VISTA

- Click **Start**, **Control Panel**, and then **User Accounts and Family Safety**

WINDOWS® XP

- Click **Start**, **Control Panel**, and then double-click **User Accounts**

MAC® OS X 10.5 OR LATER

- Click **System Preferences**, **Accounts**, and check **Allow user to administer this computer**

Complete the software installation:

- 1 Insert the Software Installation Disc into a network computer running Windows.
- 2 Follow the instructions on the computer to install the HP MediaSmart Server.
- 3 Microsoft encourages you to accept their recommended settings for Windows Update and Customer Experience settings.
- 4 Enter your Windows Home Server password to logon once the installation is complete.

Repeat the software installation on each network computer running either Windows® or Mac® OS X 10.5 or later.

HOW IT FITS IN YOUR HOME NETWORK

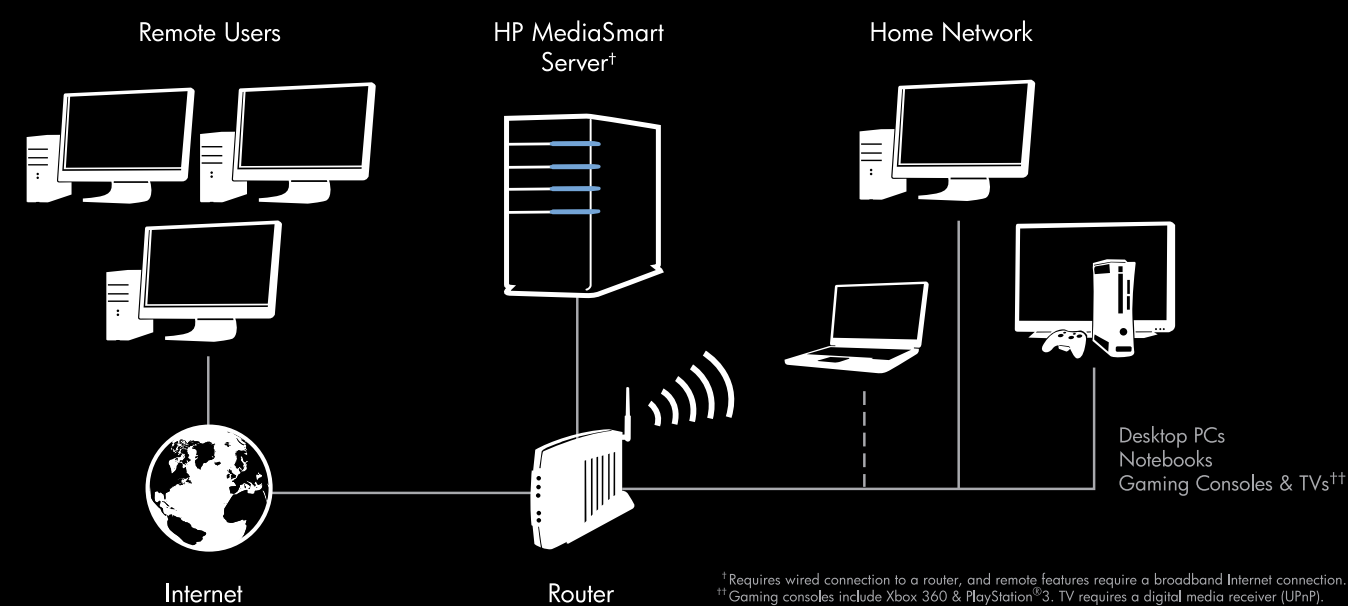

[†]Requires wired connection to a router, and remote features require a broadband Internet connection.
^{**}Gaming consoles include Xbox 360 & PlayStation 3. TV requires a digital media receiver (UPnP).

CONGRATULATIONS!

You are ready to Start Using Your Server.